

Centro 1

Assembly Instructions



Rigid Panel

1



Place base plates on the floor, position lower posts centrally over male fitting of base plate (A), and rotate until assembly drops into position, continue rotating clockwise through 90° to secure (B).

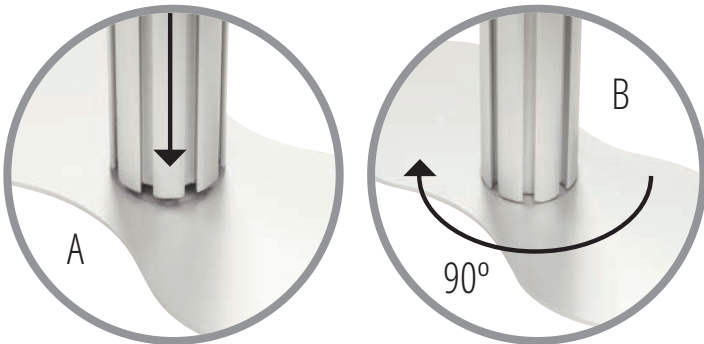

2

Affix upper posts to lower posts by positioning female end centrally over male fitting (C), and rotate until assembly drops into position, continue rotating clockwise through 90° to secure (D).

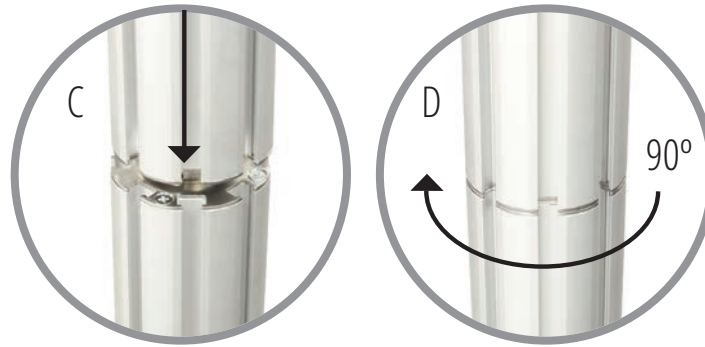

3

Assemble 750mm horizontal profiles by slotting and twisting together to join. Carefully rest ends of first horizontal assembly on base plates between posts.

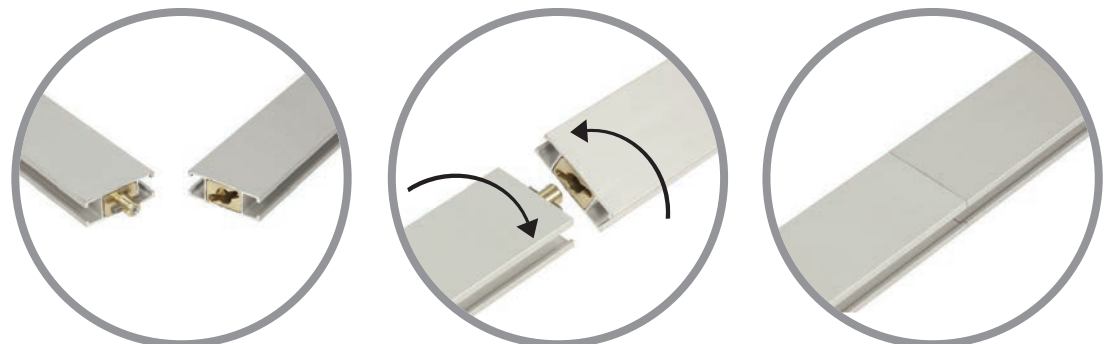

4



Slot clamps of assembled profile into post channels and tighten grub screws with hex key supplied to secure.

6



Slot second horizontal assembly onto top of rigid panel and into channels of posts. Tighten remaining grub screws to complete assembly of the display.

5



Arc and slot rigid panel into innermost channels of posts, and lower into channel of horizontal profile assembly.



Centro 1 with Rigid Panels complete



Banner Graphic

1



Place base plates on the floor, position lower posts centrally over male fitting of base plate (A), and rotate until assembly drops into position, continue rotating clockwise through 90° to secure (B).

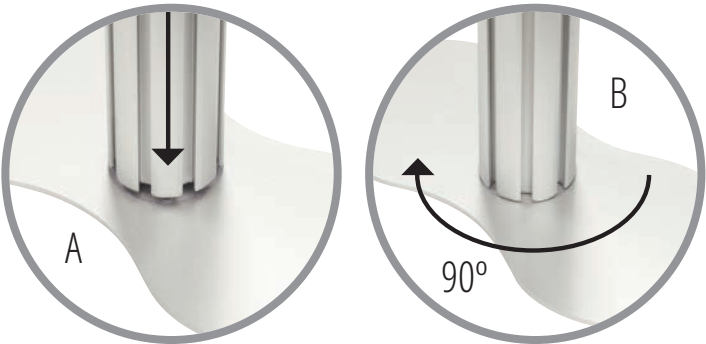

2

Affix upper posts to lower posts by positioning female end centrally over male fitting (C), and rotate until assembly drops into position, continue rotating clockwise through 90° to secure (D).

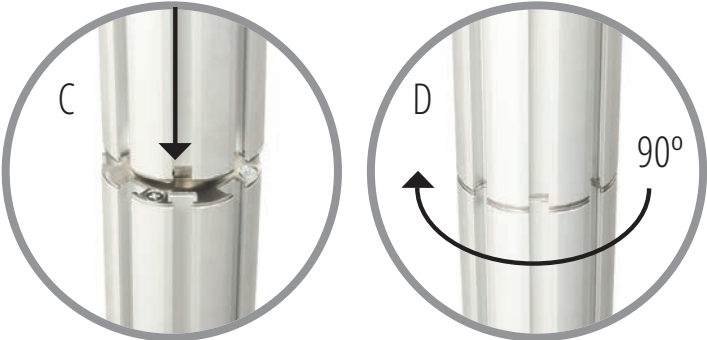

3

Assemble 750mm horizontal profiles by slotting and twisting together to join. Carefully rest ends of first horizontal assembly on base plates between posts.

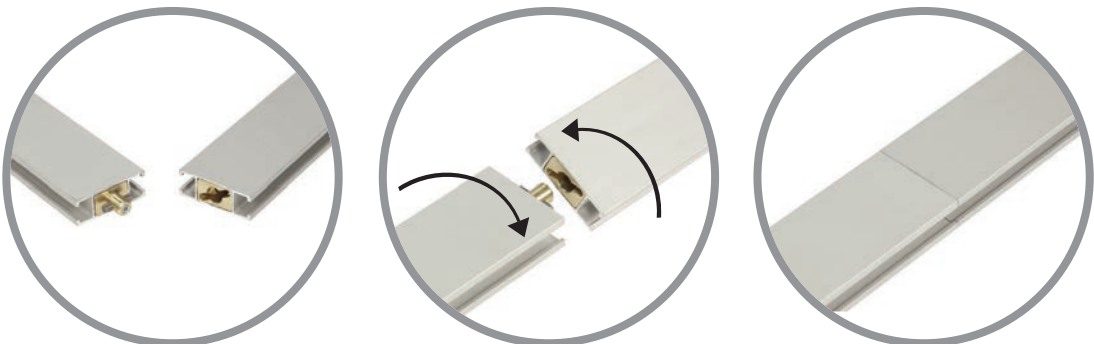

4



Slot clamps of assembled profile into post channels and tighten grub screws with hex key supplied to secure.

5



Slide second horizontal assembly into upper pocket of graphic, ensuring grub screws and hole at rear of banner are aligned.

6



Firmly holding the middle of the graphic and horizontal rail, raise banner to top of display. Slot clamp at one end of rail into post channel and tighten to secure. Repeat for opposite end of graphic.

7



Remove bottom horizontal assembly from posts and slide into lower pocket of graphic, ensuring grub screws and hole at rear of banner are aligned.

8



Tension graphic by pulling bottom horizontal downwards and secure to both posts by tightening grub screws to complete assembly of the display.

9



Centro 1 with Banner Graphic complete

